

Objectives: Work as a group on individual assignments

Me: Finish Project Plan

- * Work on Selection Criteria
- * Work on presentation

Heather will send us info on motion table capabilities

Need to determine lead times
costs
material options

Center of Gravity

Need to speak w/Machine Shop for leadtimes & other options for machine shops 1/16

*Critical Steps

- * Need Modeling finished
- *

Add to Presentation

*Project View Overall

- Slide overview for the entire presentation

First team to present on 1/20

Send out presentation 48hrs before DR

Continued to page

SIGNATURE

DATE

DISCLOSED TO AND UNDERSTOOD BY

DATE

1/13/2012

PROPRIETARY INFORMATION

for all designs

Pylons attached

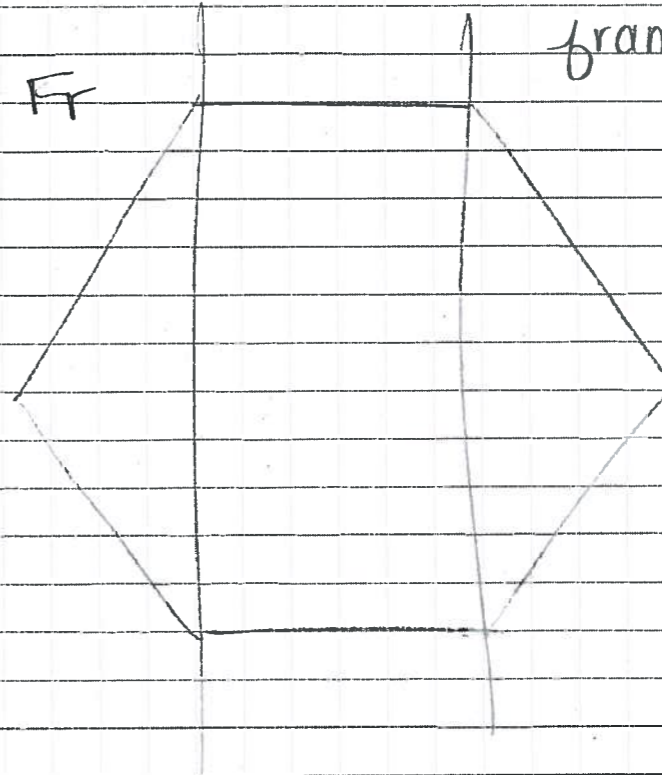
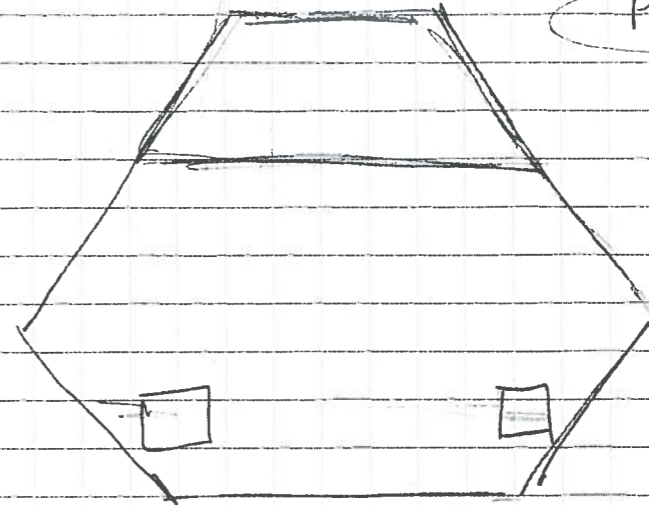
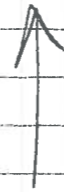

framework w/ Visual extends to accommodate brackets for display

if no display shorten tube

casters

Continued to page

SIGNATURE

DATE

DISCLOSED TO AND UNDERSTOOD BY

DATE

PROPRIETARY INFORMATION

extends to
provide
display

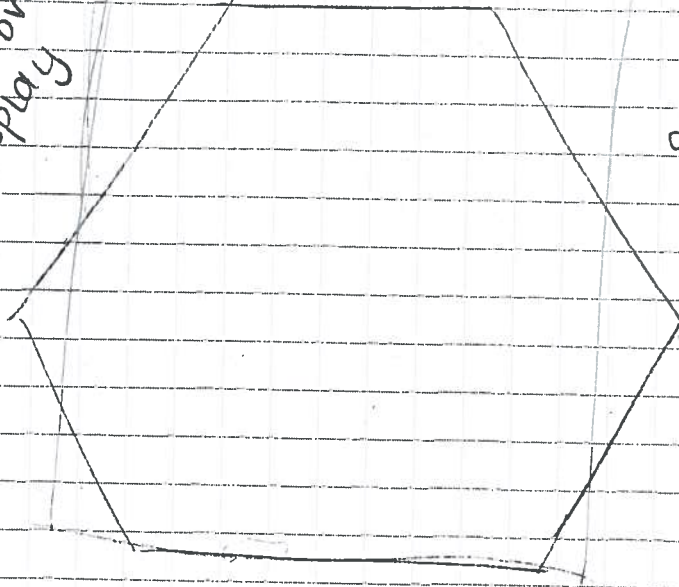

sq tubing

* casters
could be
mounted to
frame

or put casters
on both sides
posterior

Continued to page

SIGNATURE

DATE

DISCLOSED TO AND UNDERSTOOD BY

DATE

PROPRIETARY INFORMATION