

ITEM NO.	PART NUMBER	DESCRIPTION	QTY.	Price \$
1	dome		1	
2	Hole_Cover		1	0.45
3	Handles		2	1.32
4	Mixture	Cement	16.91 lbs	1.13
5	Mixture	Coconut	14.49 lbs	-
6	Mixture	Sand	19.11 lbs	0.15
7	Mixture	Styrofoam	0.245 lbs	-
8	Mixture	Glenium	28 mL	0.08
9	Mixture	Water	As Needed	-

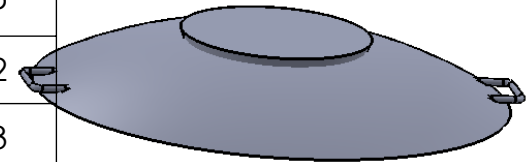

The total price is \$5.28 and weighs 47lbs



PROPRIETARY AND CONFIDENTIAL
 THE INFORMATION CONTAINED IN THIS DRAWING IS THE SOLE PROPERTY OF <INSERT COMPANY NAME HERE>. ANY REPRODUCTION IN PART OR AS A WHOLE WITHOUT THE WRITTEN PERMISSION OF <INSERT COMPANY NAME HERE> IS PROHIBITED.

		UNLESS OTHERWISE SPECIFIED:	NAME	DATE		
		DIMENSIONS ARE IN INCHES	DRAWN		TITLE:	
		TOLERANCES:	CHECKED			
		FRACTIONAL ±	ENG APPR.			
		ANGULAR: MACH ± BEND ±	MFG APPR.			
		TWO PLACE DECIMAL ±	Q.A.		SIZE DWG. NO. REV A DomeAsby	
		THREE PLACE DECIMAL ±	COMMENTS:			
		INTERPRET GEOMETRIC TOLERANCING PER:			SCALE: 1:12	WEIGHT:
		MATERIAL			SHEET 1 OF 1	
NEXT ASSY	USED ON	FINISH				
APPLICATION		DO NOT SCALE DRAWING				

5

4

3

2

1