

1/4" Diameter Orange Mesh Sleeving

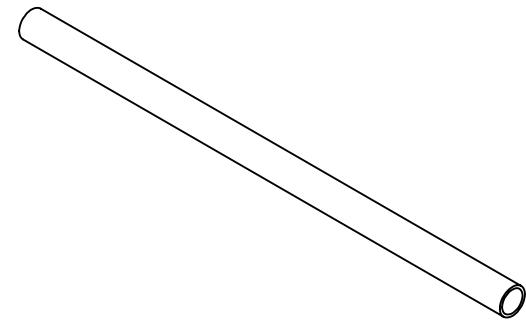

BOTH ENDS OF SLEEVING CUT WITH HEAT GUN TO PREVENT FRAYING

WORKING LENGTH OF THE AIR MUSCLE MUST BE 6"
 - MINIMUM LENGTH OF CUT OF SLEEVING IS 6.75"
 - MAXIMUM LENGTH OF CUT OF SLEEVING IS 7.15"

* DRAWING SHOWS UNCOMPRESSED SLEEVING

PROPRIETARY AND CONFIDENTIAL
 THE INFORMATION CONTAINED IN THIS DRAWING IS THE SOLE PROPERTY OF <INSERT COMPANY NAME HERE>. ANY REPRODUCTION IN PART OR AS A WHOLE WITHOUT THE WRITTEN PERMISSION OF <INSERT COMPANY NAME HERE> IS PROHIBITED.

		UNLESS OTHERWISE SPECIFIED:		NAME	DATE			
		DIMENSIONS ARE IN INCHES		DRAWN		TITLE:		
		TOLERANCES:		CHECKED				
		FRACTIONAL ±		ENG APPR.				
		ANGULAR: MACH ± BEND ±		MFG APPR.				
		TWO PLACE DECIMAL ±		Q.A.		SIZE DWG. NO. REV A Sleeve		
		THREE PLACE DECIMAL ±		COMMENTS:				
		INTERPRET GEOMETRIC TOLERANCING PER:				SCALE: 1:2	WEIGHT:	SHEET 1 OF 1
		MATERIAL						
		FINISH						
	NEXT ASSY	USED ON						
	APPLICATION		DO NOT SCALE DRAWING					