

4

3

2

1

Rev	Change	Name	Date

ITEM NO.	PART NUMBER	DESCRIPTION	Default/ QTY.
1	180001	Chamber_Base	1
2	180004	Chamber_Left_Side	1
3	180002	Chamber_Back	1
4	180012	Chamber_Top	1
5	180006	Short_Gusset	2
6	180005	Long_Gusset	2
7	180007	Chamber_Large_Slant_Plate	1
8	180011	Door_Assm	1
9	180003	Chamber_R_Side_Rev1	1
10	Front_Assm		1
11	Fixture_Support_Bar		2
12	1568A14		1
13	Door_Interlock_Lock		1
14	Door_Interlock_Base		1

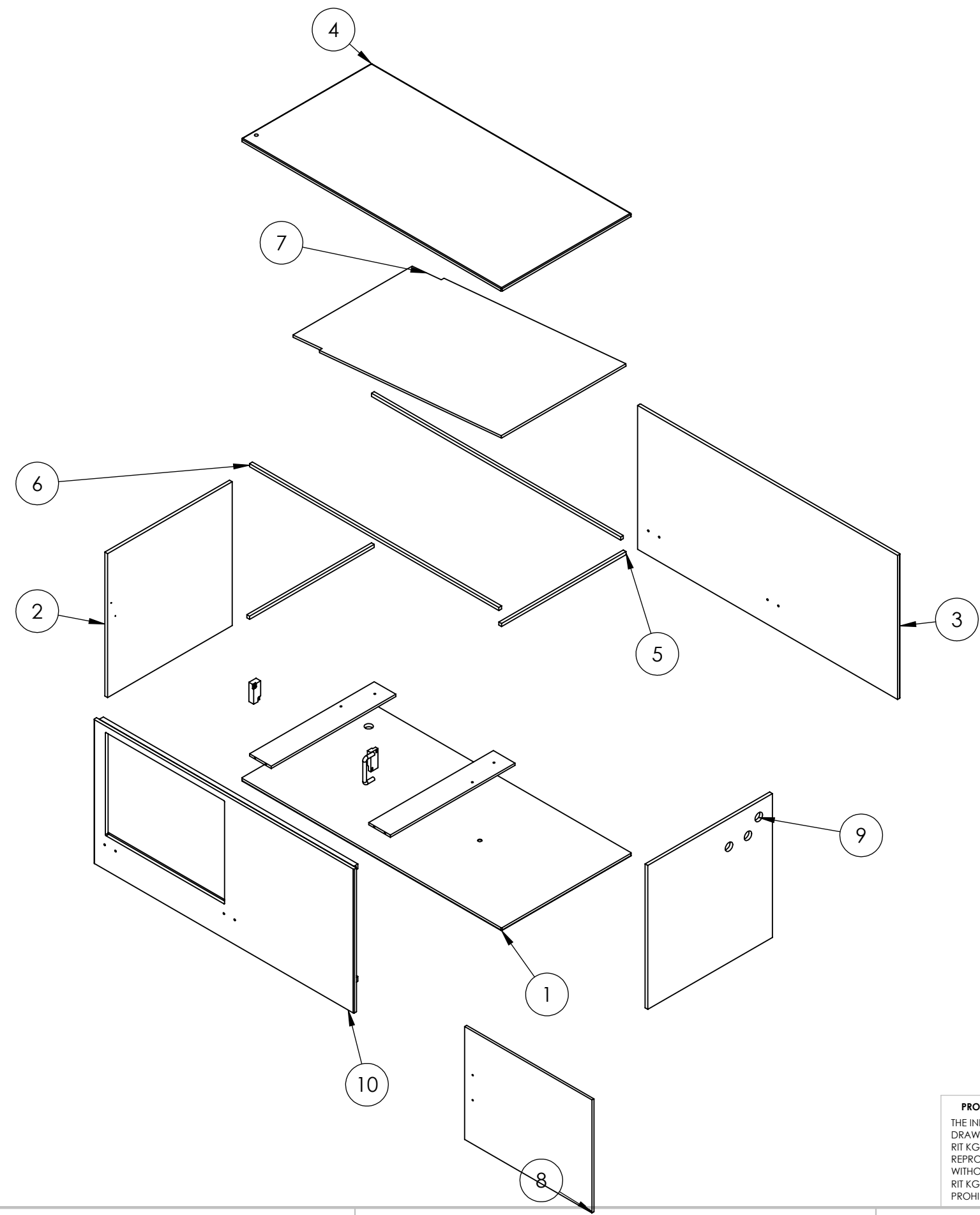

4

3

2

1

UNLESS OTHERWISE SPECIFIED:		NAME	DATE
DIMENSIONS ARE IN INCHES		DRAWN	B. Mowers 12/9/15
TOLERANCES:		CHECKED	
FRACTIONAL ±1/16		ENG APPR.	
ANGULAR: MACH ±0.5 BEND ±		MFG APPR.	
TWO PLACE DECIMAL ±0.01		Q.A.	
THREE PLACE DECIMAL ±0.003		COMMENTS:	
FOUR PLACE DECIMAL ±0.0005		1. Break all edges	
INTERPRET GEOMETRIC TOLERANCING PER:			
MATERIAL			
Polycarbonate			
FINISH			
DO NOT SCALE DRAWING			

**PROPRIETARY AND CONFIDENTIAL**  
 THE INFORMATION CONTAINED IN THIS DRAWING IS THE SOLE PROPERTY OF RIT KGCOE MSD-P16680. ANY REPRODUCTION IN PART OR AS A WHOLE WITHOUT THE WRITTEN PERMISSION OF RIT KGCOE MSD-P16680 IS PROHIBITED.

TITLE:  
**Containment Chamber**

SIZE DWG. NO. REV  
**Man\_Chamber\_Rev**

SCALE: 1:12 WEIGHT 4 SHEET 1 OF 17

B

B

A

A

4

3

2

1

Rev	Change	Name	Date

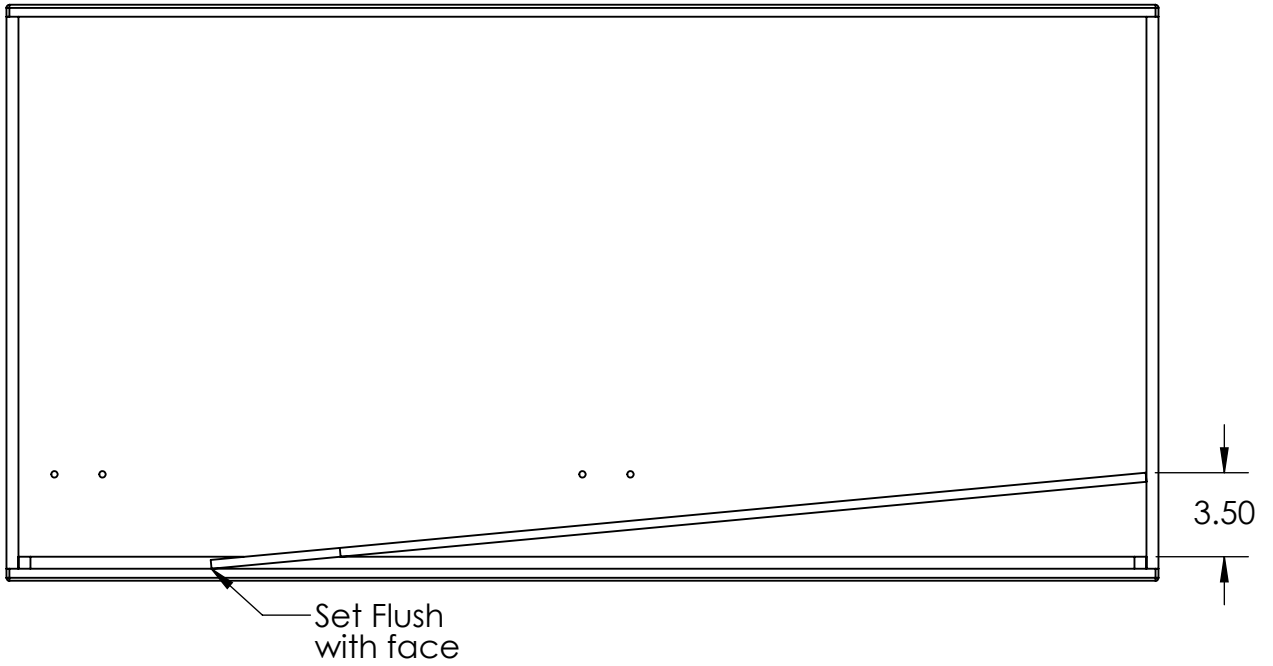

B

B

A

A

Note:

- Fill gaps
  - Gap at Right chamber side
  - Gap at Long Gussets
  - Gap at Chamber base
- Round fill at between base and slant
- Lower edges of slant contact chamber faces

**PROPRIETARY AND CONFIDENTIAL**  
 THE INFORMATION CONTAINED IN THIS DRAWING IS THE SOLE PROPERTY OF RIT KGCOE MSD-P16680. ANY REPRODUCTION IN PART OR AS A WHOLE WITHOUT THE WRITTEN PERMISSION OF RIT KGCOE MSD-P16680 IS PROHIBITED.

UNLESS OTHERWISE SPECIFIED:  
 DIMENSIONS ARE IN INCHES  
 TOLERANCES:  
 FRACTIONAL ±1/16  
 ANGULAR: MACH ±0.5 BEND ±  
 TWO PLACE DECIMAL ±0.01  
 THREE PLACE DECIMAL ±0.003  
 FOUR PLACE DECIMAL ±0.0005

INTERPRET GEOMETRIC TOLERANCING PER:  
 MATERIAL Polycarbonate  
 FINISH  
 DO NOT SCALE DRAWING

	NAME	DATE
DRAWN	B. Mowers	1/28/15
CHECKED		
ENG APPR.		
MFG APPR.		
Q.A.		
COMMENTS:	1. Break all edges	

TITLE: <b>Chamber_Assm</b>		
SIZE	DWG. NO.	REV
SCALE: 1:12 WEIGHT 4		SHEET 2 OF 17

4

3

2

1

**Man Chamber\_Rev**

4

3

2

1

Rev	Change	Name	Date

ITEM NO.	PART NUMBER	DESCRIPTION	QTY.
1	180008	Chamber_Front	1
2	180009	Upper_Door_Slide	1
3	180010	Lower_Door_Slide	1

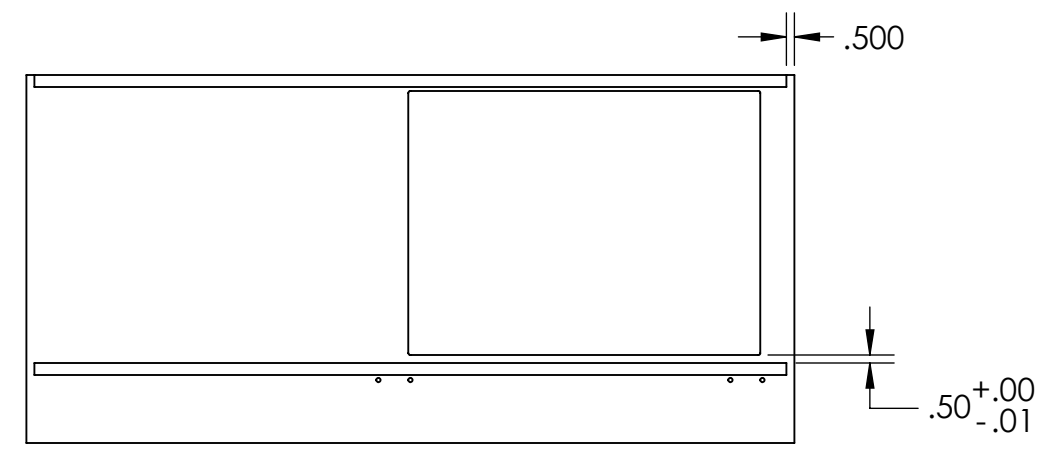
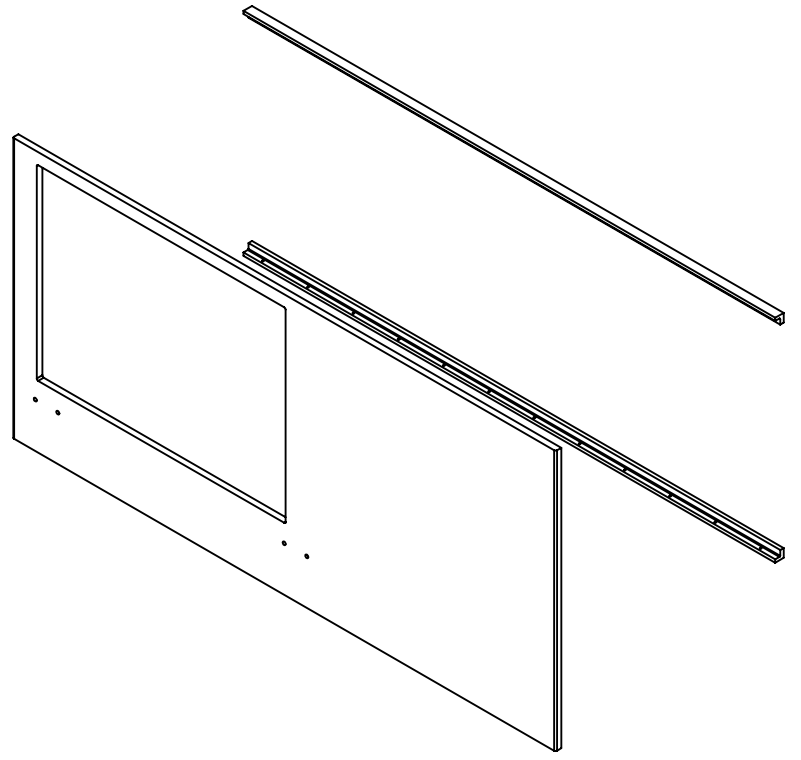

B

B

A

A

UNLESS OTHERWISE SPECIFIED:	NAME	DATE
DIMENSIONS ARE IN INCHES	DRAWN	B. Mowers 1/26/15
TOLERANCES:	CHECKED	
FRACTIONAL ±1/16	ENG APPR.	
ANGULAR: MACH ±0.5 BEND ±	MFG APPR.	
TWO PLACE DECIMAL ±0.01	Q.A.	
THREE PLACE DECIMAL ±0.003	COMMENTS:	
FOUR PLACE DECIMAL ±0.0005	1. Break all edges	
INTERPRET GEOMETRIC TOLERANCING PER:		
MATERIAL		
Polycarbonate		
FINISH		
DO NOT SCALE DRAWING		

**PROPRIETARY AND CONFIDENTIAL**  
 THE INFORMATION CONTAINED IN THIS DRAWING IS THE SOLE PROPERTY OF RIT KGCOE MSD-P16680. ANY REPRODUCTION IN PART OR AS A WHOLE WITHOUT THE WRITTEN PERMISSION OF RIT KGCOE MSD-P16680 IS PROHIBITED.

TITLE:  
**Chamber\_Front\_ Assm**

SIZE	DWG. NO.	REV
SCALE: 1:12	WEIGHT: 4	SHEET 3 OF 17

4

3

2

1

4

3

2

1

Rev	Change	Name	Date

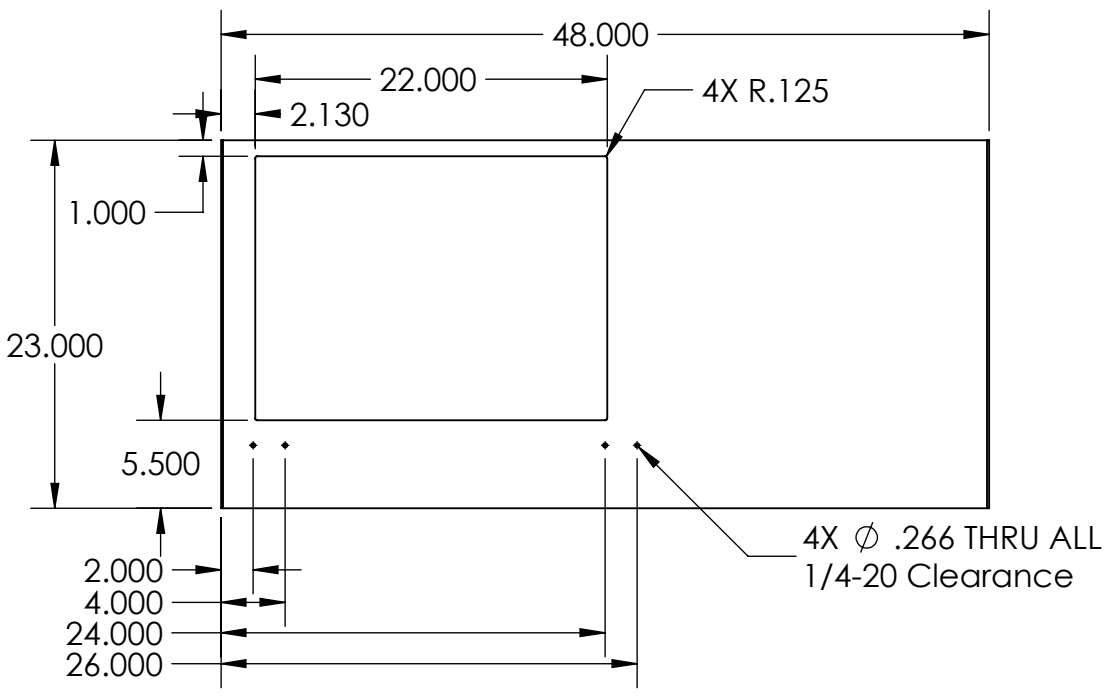
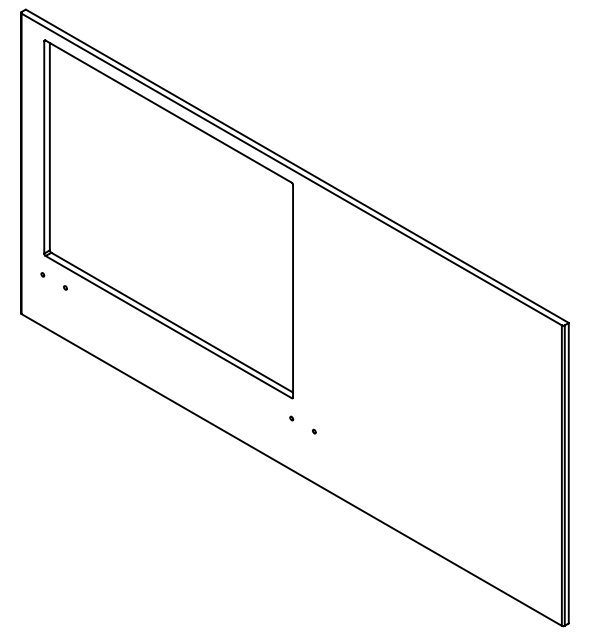
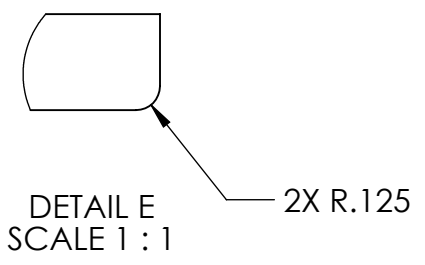
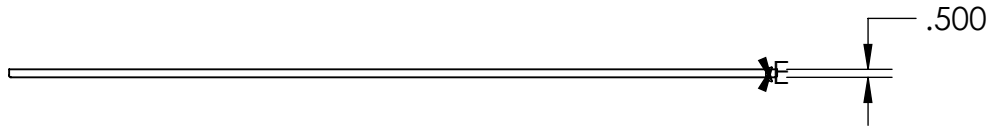

UNLESS OTHERWISE SPECIFIED:		NAME	DATE
DIMENSIONS ARE IN INCHES		DRAWN	B. Mowers 1/26/16
TOLERANCES:		CHECKED	
FRACTIONAL ±1/16		ENG APPR.	
ANGULAR: MACH ±0.5 BEND ±		MFG APPR.	
TWO PLACE DECIMAL ±0.01		Q.A.	
THREE PLACE DECIMAL ±0.003		COMMENTS:	
FOUR PLACE DECIMAL ±0.0005		1. Break all edges	
INTERPRET GEOMETRIC TOLERANCING PER:	MATERIAL		
	Polycarbonate		
	FINISH		
	DO NOT SCALE DRAWING		

**PROPRIETARY AND CONFIDENTIAL**  
 THE INFORMATION CONTAINED IN THIS DRAWING IS THE SOLE PROPERTY OF RIT KGCOE MSD-P16680. ANY REPRODUCTION IN PART OR AS A WHOLE WITHOUT THE WRITTEN PERMISSION OF RIT KGCOE MSD-P16680 IS PROHIBITED.

TITLE:		
Chamber_Front		
P/N: 180008		
SIZE	DWG. NO.	REV
SCALE: 1:12 WEIGHT: 4		SHEET 4 OF 17

**Man Chamber\_Rev**

B

B

A

A

4

3

2

1

Rev	Change	Name	Date
1	Changed to Nominal - 0.75"	BM	1/16

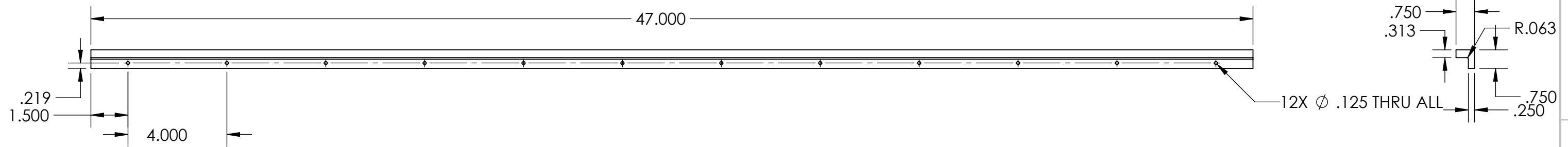
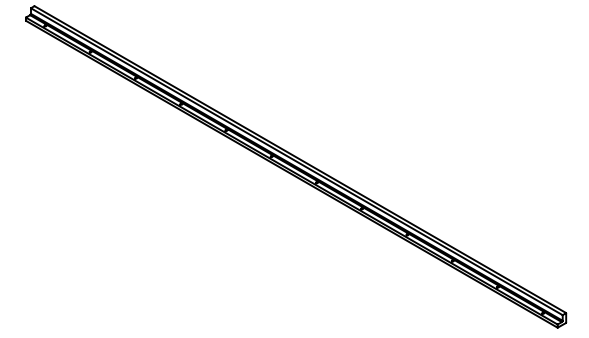

Note:  
 1. Scale 1:4  
 2. Pattern holes with 4" center-to-center

UNLESS OTHERWISE SPECIFIED:		NAME	DATE
DIMENSIONS ARE IN INCHES		DRAWN	B. Mowers 1/26/16
TOLERANCES:		CHECKED	
FRACTIONAL ±1/16		ENG APPR.	
ANGULAR: MACH ±0.5 BEND ±		MFG APPR.	
TWO PLACE DECIMAL ±0.01		Q.A.	
THREE PLACE DECIMAL ±0.003		COMMENTS:	
FOUR PLACE DECIMAL ±0.0005		1. Break all edges	
INTERPRET GEOMETRIC TOLERANCING PER:			
MATERIAL	Polycarbonate		
FINISH			
DO NOT SCALE DRAWING			

**PROPRIETARY AND CONFIDENTIAL**  
 THE INFORMATION CONTAINED IN THIS DRAWING IS THE SOLE PROPERTY OF RIT KGCOE MSD-P16680. ANY REPRODUCTION IN PART OR AS A WHOLE WITHOUT THE WRITTEN PERMISSION OF RIT KGCOE MSD-P16680 IS PROHIBITED.

TITLE: <b>Lower_Door_Track</b> <b>P/N: 180010</b>		
SIZE	DWG. NO.	REV
SCALE: 1:12 WEIGHT: 4		SHEET 5 OF 17

**Main Chamber\_Rev**

4

3

2

1

Rev	Change	Name	Date
1	Changed to Nominal - 0.75"	BM	1/16

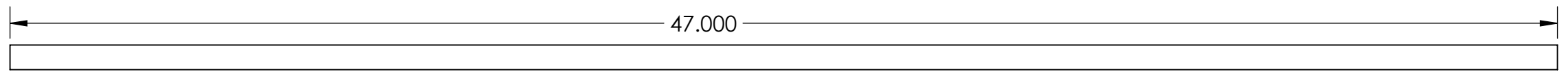
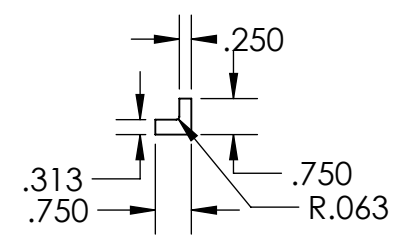
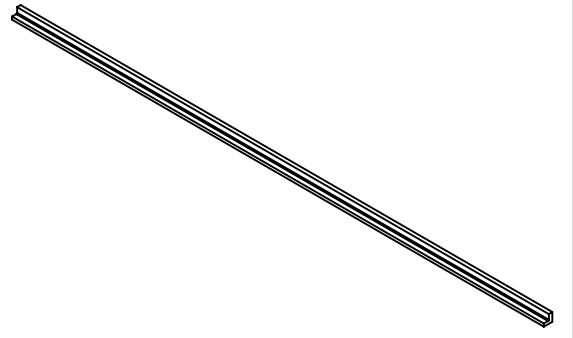

B

B

A

A

Note:  
1. Scale 1:4

UNLESS OTHERWISE SPECIFIED:

DIMENSIONS ARE IN INCHES  
TOLERANCES:  
FRACTIONAL ±1/16  
ANGULAR: MACH ±0.5 BEND ±  
TWO PLACE DECIMAL ±0.01  
THREE PLACE DECIMAL ±0.003  
FOUR PLACE DECIMAL ±0.0005

INTERPRET GEOMETRIC  
TOLERANCING PER:

MATERIAL  
Polycarbonate

FINISH

DO NOT SCALE DRAWING

NAME	DATE
DRAWN B. Mowers	1/26/16
CHECKED	
ENG APPR.	
MFG APPR.	
Q.A.	

COMMENTS:  
1. Break all edges

TITLE:  
Upper\_Door\_Slide  
P/N: 180009

SIZE	DWG. NO.	REV

Man Chamber\_Rev

SCALE: 1:12 WEIGHT: 4 SHEET 6 OF 17

4

3

2

1

Rev	Change	Name	Date
1	Drain Hole Moved 0.5"	BM	1/16
1	Secondary Drain added	BM	2/1

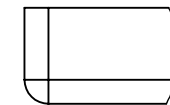
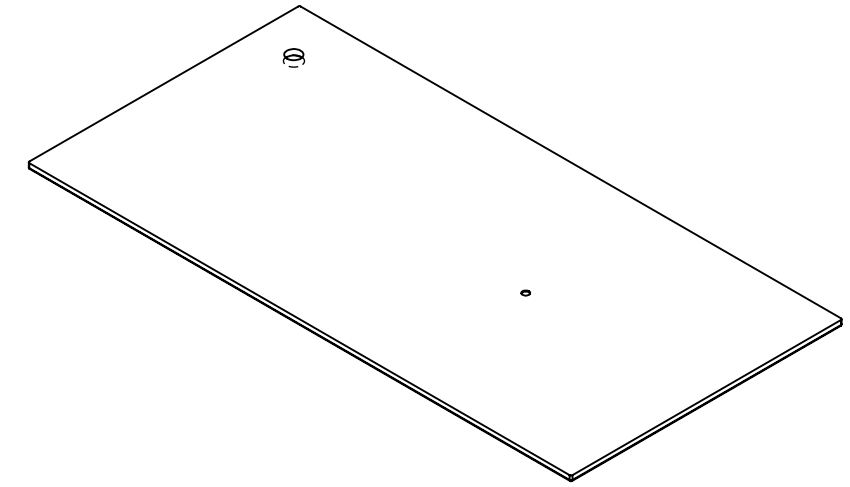
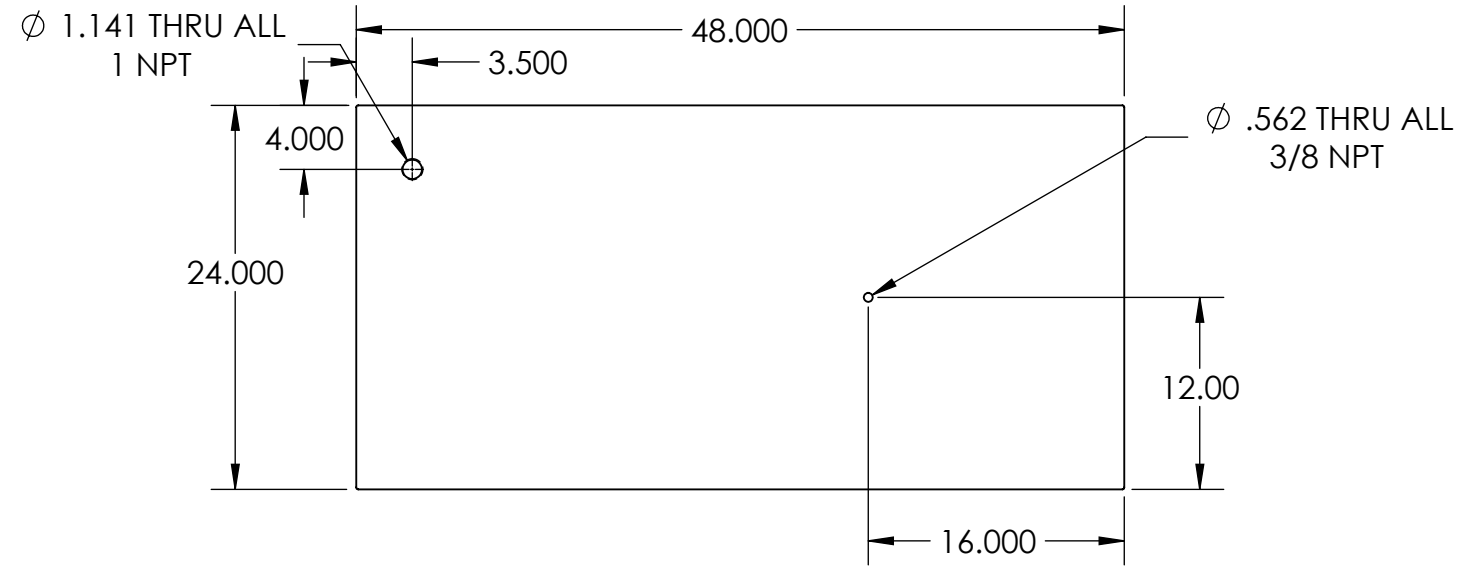

DETAIL A  
SCALE 1 : 1

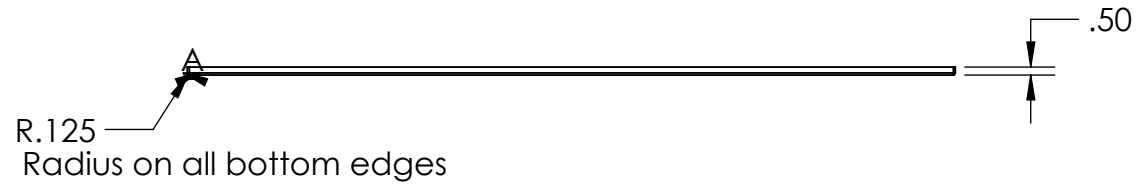

UNLESS OTHERWISE SPECIFIED:		NAME	DATE
DIMENSIONS ARE IN INCHES		DRAWN	B. Mowers 2/1/16
TOLERANCES:		CHECKED	
FRACTIONAL $\pm 1/16$		ENG APPR.	
ANGULAR: MACH $\pm 0.5$ BEND $\pm$		MFG APPR.	
TWO PLACE DECIMAL $\pm 0.01$		Q.A.	
THREE PLACE DECIMAL $\pm 0.003$		COMMENTS:	
FOUR PLACE DECIMAL $\pm 0.0005$		1. Break all edges	
INTERPRET GEOMETRIC TOLERANCING PER:			
MATERIAL			
Polycarbonate			
FINISH			
DO NOT SCALE DRAWING			

SIZE	DWG. NO.	REV

TITLE:  
**Chamber\_Base**  
**P/N: 180001**

SCALE: 1:12 WEIGHT: 4 SHEET 7 OF 17

**PROPRIETARY AND CONFIDENTIAL**  
THE INFORMATION CONTAINED IN THIS DRAWING IS THE SOLE PROPERTY OF RIT KGCOE MSD-P16680. ANY REPRODUCTION IN PART OR AS A WHOLE WITHOUT THE WRITTEN PERMISSION OF RIT KGCOE MSD-P16680 IS PROHIBITED.

**Man Chamber\_Rev**

4

3

2

1

Rev	Change	Name	Date
A	Door Interlock Holes Added	B.M.	12/15/15

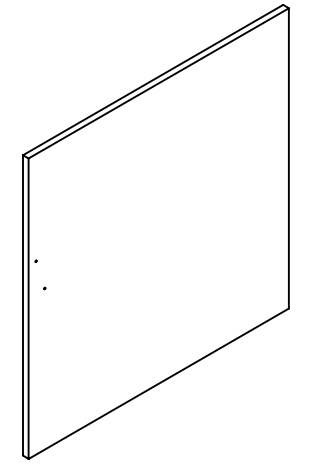

B

B

A

A

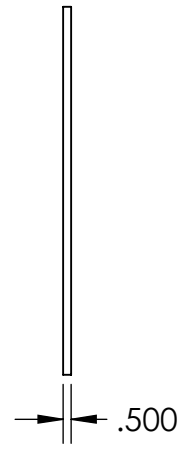
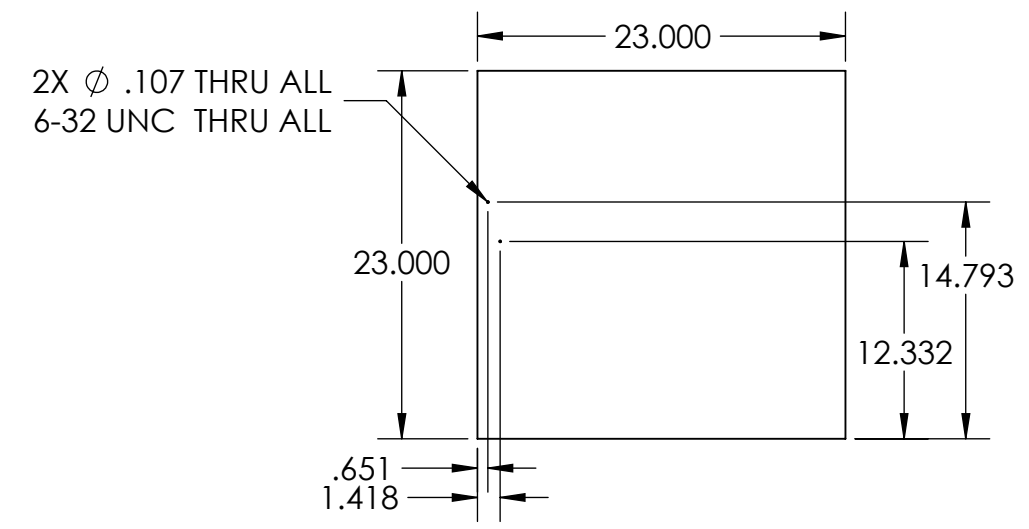

UNLESS OTHERWISE SPECIFIED:		NAME	DATE
DIMENSIONS ARE IN INCHES		DRAWN	B. Mowers 12/9/15
TOLERANCES:		CHECKED	
FRACTIONAL $\pm 1/16$		ENG APPR.	
ANGULAR: MACH $\pm 0.5$ BEND $\pm$		MFG APPR.	
TWO PLACE DECIMAL $\pm 0.01$		Q.A.	
THREE PLACE DECIMAL $\pm 0.003$		COMMENTS:	
FOUR PLACE DECIMAL $\pm 0.0005$		1. Break all edges	
INTERPRET GEOMETRIC TOLERANCING PER:			
MATERIAL			
Polycarbonate			
FINISH			
DO NOT SCALE DRAWING			

**PROPRIETARY AND CONFIDENTIAL**  
 THE INFORMATION CONTAINED IN THIS DRAWING IS THE SOLE PROPERTY OF RIT KGCOE MSD-P16680. ANY REPRODUCTION IN PART OR AS A WHOLE WITHOUT THE WRITTEN PERMISSION OF RIT KGCOE MSD-P16680 IS PROHIBITED.

TITLE:  
**Left\_Side\_Panel**  
**P/N: 180004**

SIZE DWG. NO. REV  
**Man Chamber\_Rev**

SCALE: 1:12 WEIGHT 4 SHEET 8 OF 17

4

3

2

1



4

3

2

1

Rev	Change	Name	Date
1	Air port added	B.M.	12/18/15
2	Exhaust Air port added	B.M.	1/28/16

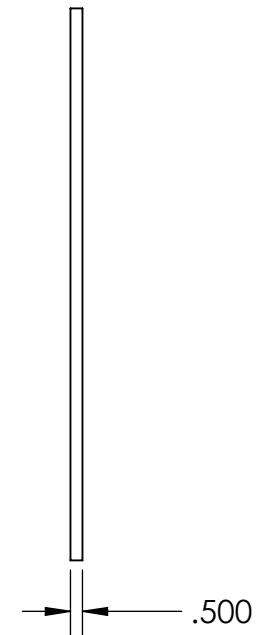
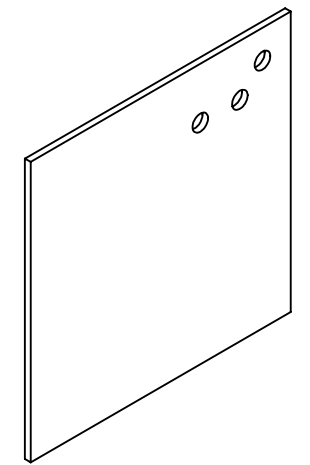
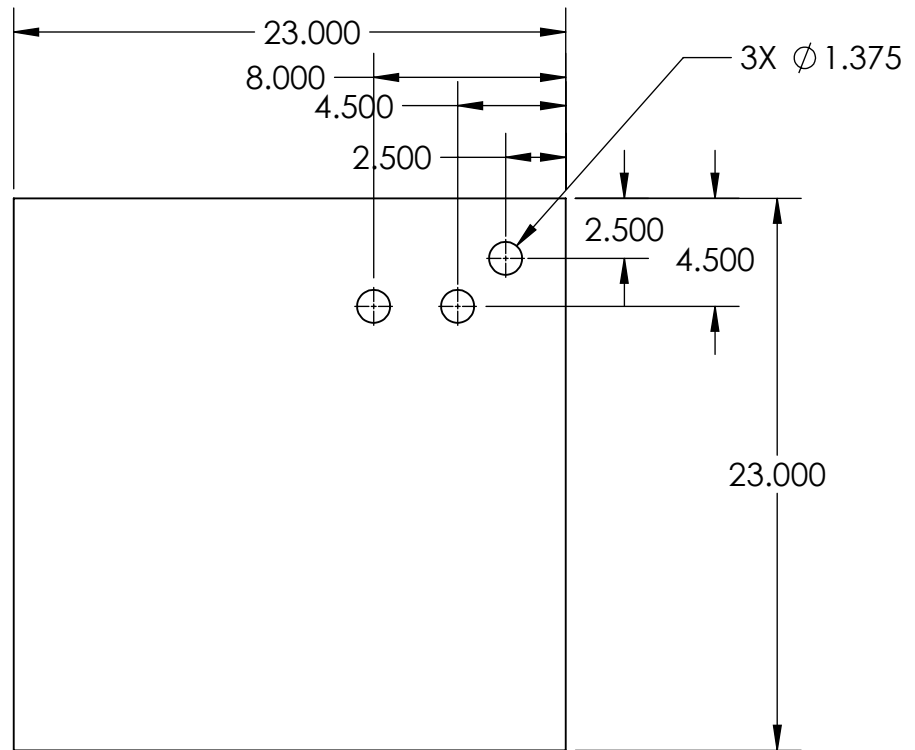

B

B

A

A

Note:  
1. Scale 1:8

UNLESS OTHERWISE SPECIFIED:	NAME	DATE
DIMENSIONS ARE IN INCHES	DRAWN	B. Mowers 1/28/16
TOLERANCES:	CHECKED	
FRACTIONAL ±1/16	ENG APPR.	
ANGULAR: MACH ±0.5 BEND ±	MFG APPR.	
TWO PLACE DECIMAL ±0.01	Q.A.	
THREE PLACE DECIMAL ±0.003	COMMENTS:	
FOUR PLACE DECIMAL ±0.0005	1. Break all edges	
INTERPRET GEOMETRIC TOLERANCING PER:		
MATERIAL		
Polycarbonate		
FINISH		
DO NOT SCALE DRAWING		

**PROPRIETARY AND CONFIDENTIAL**  
THE INFORMATION CONTAINED IN THIS DRAWING IS THE SOLE PROPERTY OF RIT KGCOE MSD-P16680. ANY REPRODUCTION IN PART OR AS A WHOLE WITHOUT THE WRITTEN PERMISSION OF RIT KGCOE MSD-P16680 IS PROHIBITED.

TITLE:  
**Right\_Side\_Panel**  
**P/N: 180003**

**Man Chamber\_Rev**

SIZE	DWG. NO.	REV

SCALE: 1:12 WEIGHT: 4 SHEET 9 OF 17

4

3

2

1

4

3

2

1

Rev	Change	Name	Date

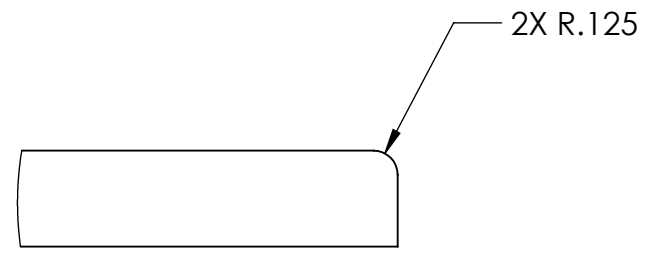
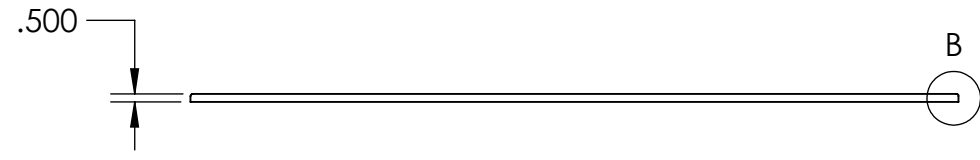

DETAIL B  
SCALE 1 : 1

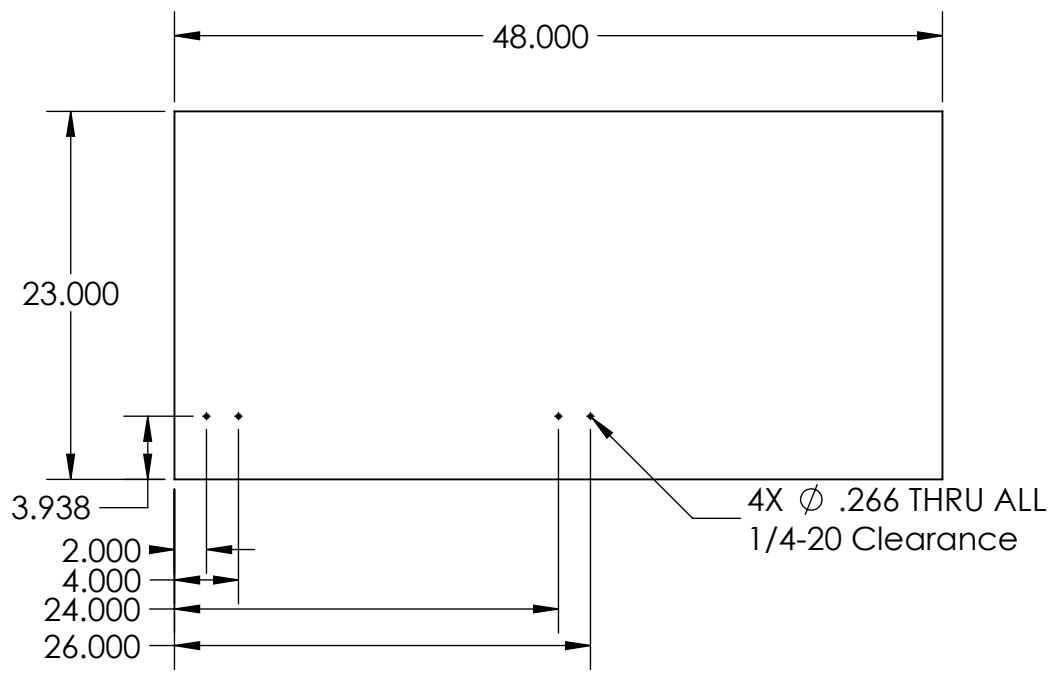
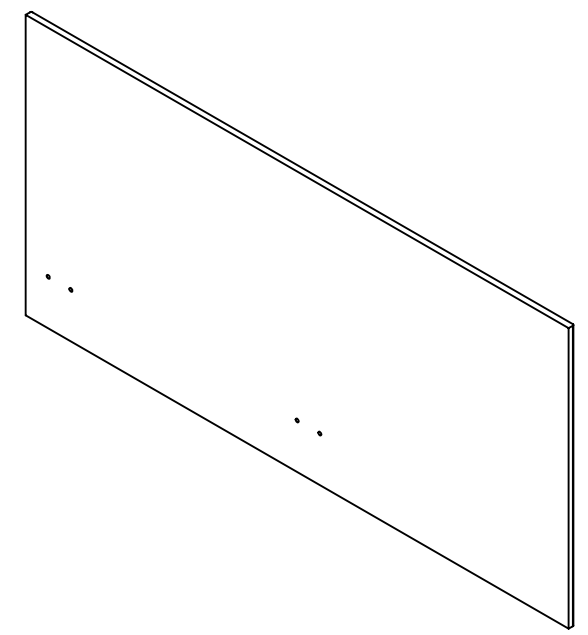

UNLESS OTHERWISE SPECIFIED:		NAME	DATE
DIMENSIONS ARE IN INCHES		DRAWN	B. Mowers 12/9/15
TOLERANCES:		CHECKED	
FRACTIONAL $\pm$ 1/16		ENG APPR.	
ANGULAR: MACH $\pm$ 0.5 BEND $\pm$		MFG APPR.	
TWO PLACE DECIMAL $\pm$ 0.01		Q.A.	
THREE PLACE DECIMAL $\pm$ 0.003		COMMENTS:	
FOUR PLACE DECIMAL $\pm$ 0.0005		1. Break all edges	
INTERPRET GEOMETRIC TOLERANCING PER:	MATERIAL	SIZE	DWG. NO.
	Polycarbonate		
	FINISH		REV
	DO NOT SCALE DRAWING		

**PROPRIETARY AND CONFIDENTIAL**  
THE INFORMATION CONTAINED IN THIS DRAWING IS THE SOLE PROPERTY OF RIT KGCOE MSD-P16680. ANY REPRODUCTION IN PART OR AS A WHOLE WITHOUT THE WRITTEN PERMISSION OF RIT KGCOE MSD-P16680 IS PROHIBITED.

TITLE:  
**Chamber\_Back**  
**P/N: 180002**

**Man Chamber\_Rev**

4

3

2

1

B

B

A

A

4

3

2

1

Rev	Change	Name	Date
1	Door Interlock port added	BM	1/28/16

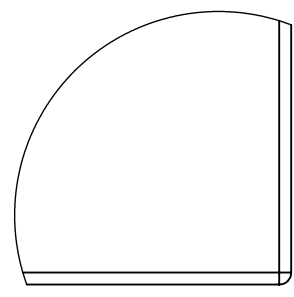
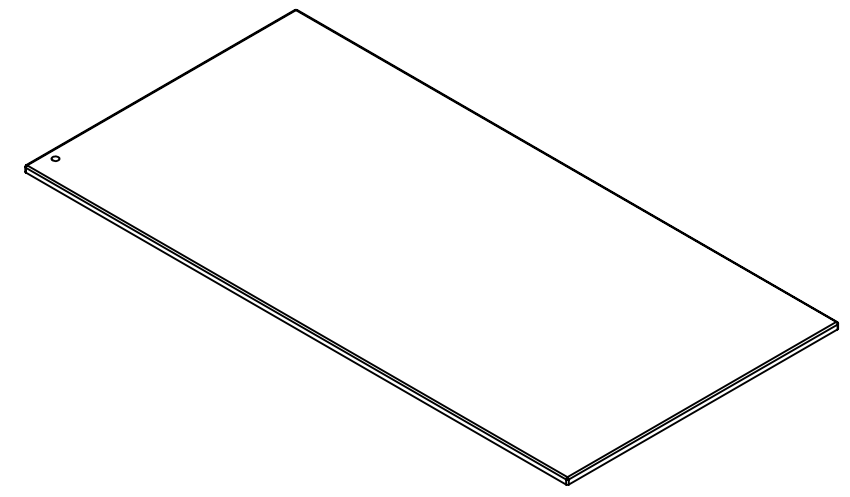
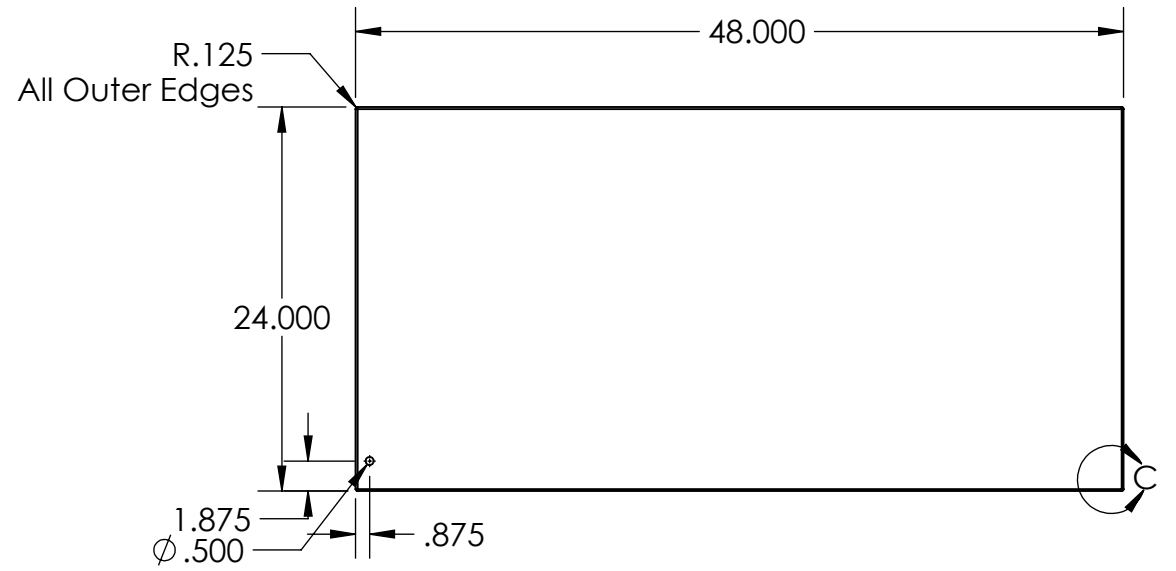

DETAIL C  
SCALE 1 : 2



**PROPRIETARY AND CONFIDENTIAL**  
THE INFORMATION CONTAINED IN THIS DRAWING IS THE SOLE PROPERTY OF RIT KGCOE MSD-P16680. ANY REPRODUCTION IN PART OR AS A WHOLE WITHOUT THE WRITTEN PERMISSION OF RIT KGCOE MSD-P16680 IS PROHIBITED.

UNLESS OTHERWISE SPECIFIED:		NAME	DATE
DIMENSIONS ARE IN INCHES		DRAWN	B. Mowers 1/28/16
TOLERANCES:		CHECKED	
FRACTIONAL $\pm 1/16$		ENG APPR.	
ANGULAR: MACH $\pm 0.5$ BEND $\pm$		MFG APPR.	
TWO PLACE DECIMAL $\pm 0.01$		Q.A.	
THREE PLACE DECIMAL $\pm 0.003$		COMMENTS:	
FOUR PLACE DECIMAL $\pm 0.0005$		1. Break all edges	
INTERPRET GEOMETRIC TOLERANCING PER:			
MATERIAL	Polycarbonate		
FINISH			
DO NOT SCALE DRAWING			

TITLE:  
**Chamber\_Top**  
**P/N: 180012**

Man Chamber\_Rev

SIZE	DWG. NO.	REV

4

3

2

1

B

B

A

A

4

3

2

1

Rev	Change	Name	Date

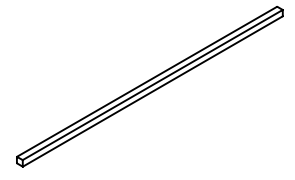
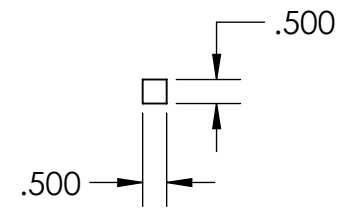
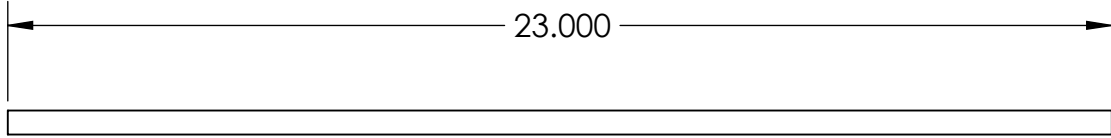

B

B

A

A

Note:  
1. Scale 1:4

**PROPRIETARY AND CONFIDENTIAL**  
 THE INFORMATION CONTAINED IN THIS DRAWING IS THE SOLE PROPERTY OF RIT KGCOE MSD-P16680. ANY REPRODUCTION IN PART OR AS A WHOLE WITHOUT THE WRITTEN PERMISSION OF RIT KGCOE MSD-P16680 IS PROHIBITED.

UNLESS OTHERWISE SPECIFIED:  
 DIMENSIONS ARE IN INCHES  
 TOLERANCES:  
 FRACTIONAL ±1/16  
 ANGULAR: MACH ±0.5 BEND ±  
 TWO PLACE DECIMAL ±0.01  
 THREE PLACE DECIMAL ±0.003  
 FOUR PLACE DECIMAL ±0.0005

INTERPRET GEOMETRIC TOLERANCING PER:  
 MATERIAL Polycarbonate  
 FINISH  
 DO NOT SCALE DRAWING

	NAME	DATE
DRAWN	B. Mowers	12/15/15
CHECKED		
ENG APPR.		
MFG APPR.		
Q.A.		
COMMENTS:	1. Break all edges	

TITLE: <b>Short_Gusset</b> <b>P/N: 180006</b>		
SIZE	DWG. NO.	REV
SCALE: 1:12	WEIGHT: 4	SHEET 12 OF 17

4

3

2

1

**Main Chamber\_Rev**

4

3

2

1

Rev	Change	Name	Date

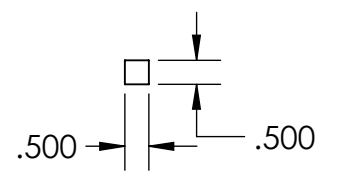
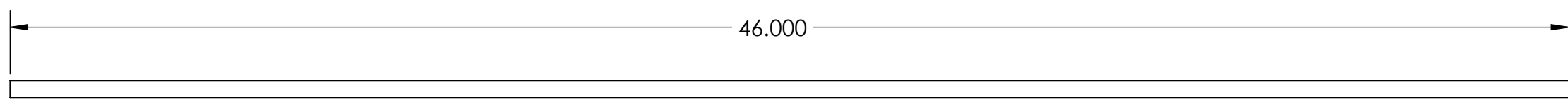
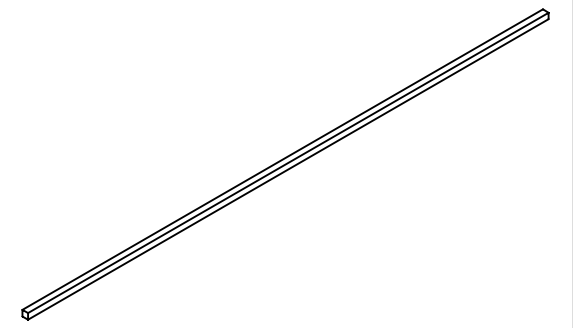

B

B

A

A

Note:  
1. Scale 1:4

UNLESS OTHERWISE SPECIFIED:

DIMENSIONS ARE IN INCHES  
TOLERANCES:  
FRACTIONAL ±1/16  
ANGULAR: MACH ±0.5 BEND ±  
TWO PLACE DECIMAL ±0.01  
THREE PLACE DECIMAL ±0.003  
FOUR PLACE DECIMAL ±0.0005

**PROPRIETARY AND CONFIDENTIAL**  
THE INFORMATION CONTAINED IN THIS  
DRAWING IS THE SOLE PROPERTY OF  
RIT KGCOE MSD-P16680. ANY  
REPRODUCTION IN PART OR AS A WHOLE  
WITHOUT THE WRITTEN PERMISSION OF  
RIT KGCOE MSD-P16680 IS  
PROHIBITED.

INTERPRET GEOMETRIC  
TOLERANCING PER:  
MATERIAL Polycarbonate  
FINISH  
DO NOT SCALE DRAWING

	NAME	DATE
DRAWN	B. Mowers	12/15/15
CHECKED		
ENG APPR.		
MFG APPR.		
Q.A.		
COMMENTS:	1. Break all edges	

TITLE: <b>Long_Gusset</b> <b>P/N: 180005</b>		
SIZE	DWG. NO.	REV
Man_Chamber_Rev		4
SCALE: 1:12 WEIGHT		SHEET 13 OF 17

4

3

2

1

4

3

2

1

Rev	Change	Name	Date
1	Removed Angles	BM	1/28/16

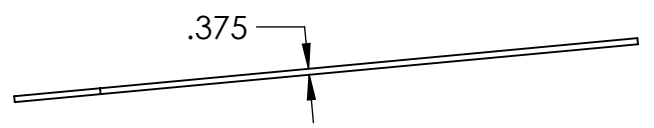
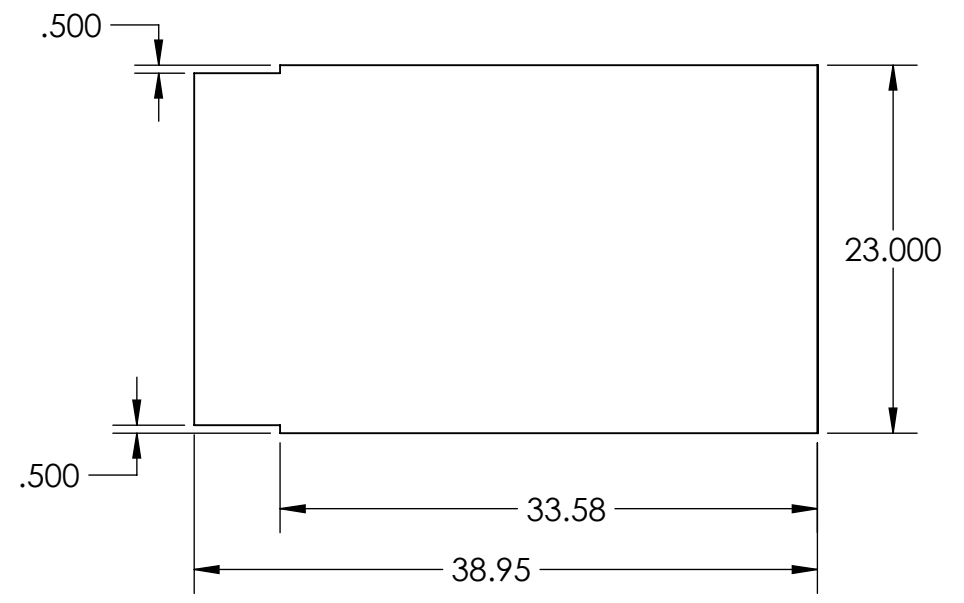
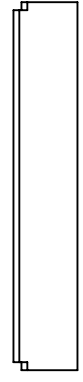

B

B

A

A

UNLESS OTHERWISE SPECIFIED:		NAME	DATE
DIMENSIONS ARE IN INCHES		DRAWN	B. Mowers 1/28/16
TOLERANCES:		CHECKED	
FRACTIONAL ±1/16		ENG APPR.	
ANGULAR: MACH ±0.5 BEND ±		MFG APPR.	
TWO PLACE DECIMAL ±0.01		Q.A.	
THREE PLACE DECIMAL ±0.003		COMMENTS:	
FOUR PLACE DECIMAL ±0.0005		1. Break all edges	
INTERPRET GEOMETRIC TOLERANCING PER:			
MATERIAL			
Polycarbonate			
FINISH			
DO NOT SCALE DRAWING			

**PROPRIETARY AND CONFIDENTIAL**  
 THE INFORMATION CONTAINED IN THIS DRAWING IS THE SOLE PROPERTY OF RIT KGCOE MSD-P16680. ANY REPRODUCTION IN PART OR AS A WHOLE WITHOUT THE WRITTEN PERMISSION OF RIT KGCOE MSD-P16680 IS PROHIBITED.

TITLE:		
Slant_Plate		
P/N: 180007		
SIZE	DWG. NO.	REV
SCALE: 1:12		WEIGHT: 4
		SHEET 14 OF 17

**Man Chamber\_Rev**

4

3

2

1

4

3

2

1

Rev	Change	Name	Date

ITEM NO.	PART NUMBER	DESCRIPTION	QTY.
1	180011.1	Chamber_Door	1
2	180011.2	Door_Interlock_Lock_Mount	1

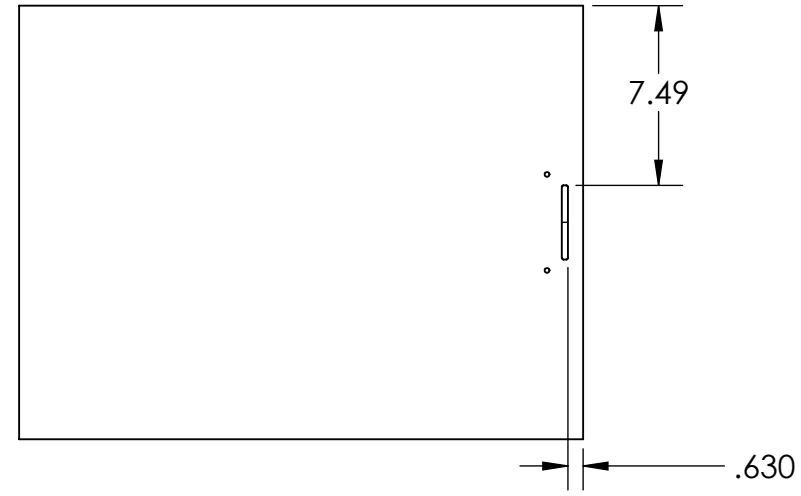
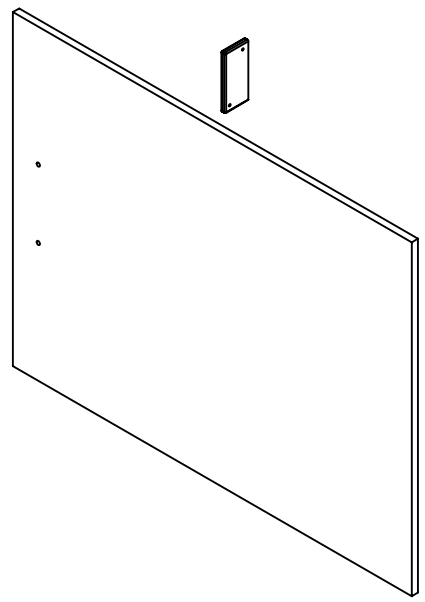

Note:  
 1. Scale 1:8  
 2. Pre-assemble before installing in chamber

**PROPRIETARY AND CONFIDENTIAL**  
 THE INFORMATION CONTAINED IN THIS DRAWING IS THE SOLE PROPERTY OF RIT KGCOE MSD-P16680. ANY REPRODUCTION IN PART OR AS A WHOLE WITHOUT THE WRITTEN PERMISSION OF RIT KGCOE MSD-P16680 IS PROHIBITED.

UNLESS OTHERWISE SPECIFIED:  
 DIMENSIONS ARE IN INCHES  
 TOLERANCES:  
 FRACTIONAL ±1/16  
 ANGULAR: MACH ±0.5 BEND ±  
 TWO PLACE DECIMAL ±0.01  
 THREE PLACE DECIMAL ±0.003  
 FOUR PLACE DECIMAL ±0.0005

INTERPRET GEOMETRIC TOLERANCING PER:  
 MATERIAL Polycarbonate  
 FINISH  
 DO NOT SCALE DRAWING

	NAME	DATE
DRAWN	B. Mowers	12/15/15
CHECKED		
ENG APPR.		
MFG APPR.		
Q.A.		

TITLE:  
**Door\_Subassembly**  
**P/N: 180011**

SIZE DWG. NO. REV  
**Man Chamber\_Rev**

4

3

2

1

B

B

A

A

4

3

2

1

Rev	Change	Name	Date

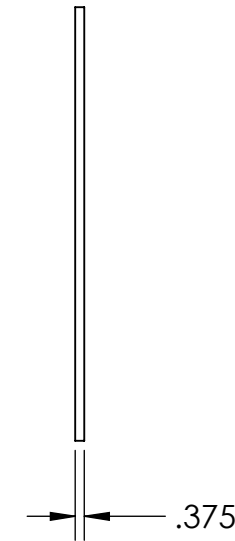
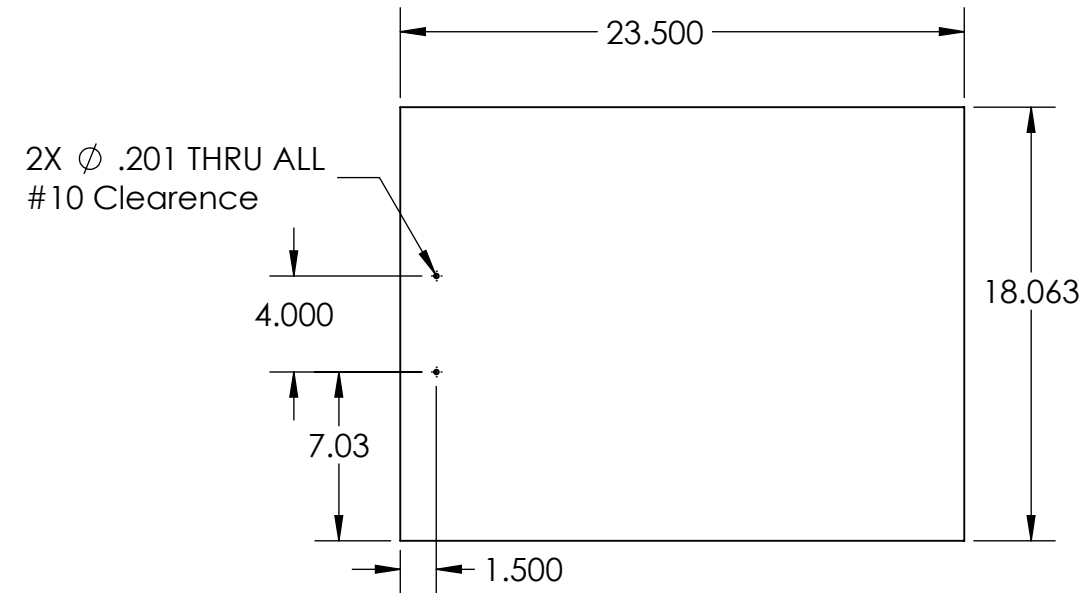

Note:  
 1. Scale 1:8  
 2. Pre-assemble before installing in chamber

**PROPRIETARY AND CONFIDENTIAL**  
 THE INFORMATION CONTAINED IN THIS DRAWING IS THE SOLE PROPERTY OF RIT KGCOE MSD-P16680. ANY REPRODUCTION IN PART OR AS A WHOLE WITHOUT THE WRITTEN PERMISSION OF RIT KGCOE MSD-P16680 IS PROHIBITED.

UNLESS OTHERWISE SPECIFIED:		NAME	DATE
DIMENSIONS ARE IN INCHES		DRAWN	B. Mowers 12/15/15
TOLERANCES:		CHECKED	
FRACTIONAL ±1/16		ENG APPR.	
ANGULAR: MACH ±0.5 BEND ±		MFG APPR.	
TWO PLACE DECIMAL ±0.01		Q.A.	
THREE PLACE DECIMAL ±0.003		COMMENTS:	
FOUR PLACE DECIMAL ±0.0005		1. Break all edges	
INTERPRET GEOMETRIC TOLERANCING PER:	MATERIAL		
	Polycarbonate		
	FINISH		
	DO NOT SCALE DRAWING		

TITLE:  
**Chamber\_Door**  
**P/N: 180011.1**

SIZE DWG. NO. REV  
**Man Chamber\_Rev**

SCALE: 1:12 WEIGHT: 4 SHEET 16 OF 17

4

3

2

1

B

B

A

A



4

3

2

1

Rev	Change	Name	Date

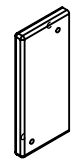

2X  $\phi$  .107 THRU ALL  
6-32 UNC THRU ALL

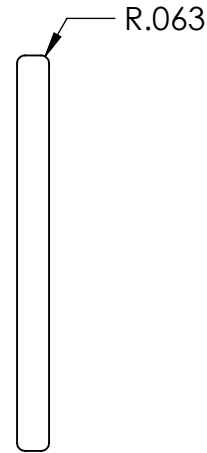
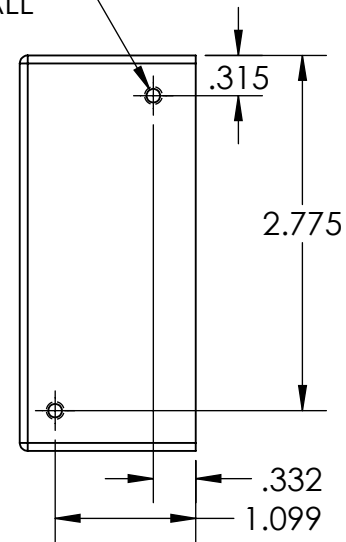

- Note:
- Scale 2:3
  - Do NOT radius mating face
  - Pre-assemble before installing in chamber

UNLESS OTHERWISE SPECIFIED:

DIMENSIONS ARE IN INCHES  
TOLERANCES:  
FRACTIONAL  $\pm 1/16$   
ANGULAR: MACH  $\pm 0.5$  BEND  $\pm$   
TWO PLACE DECIMAL  $\pm 0.01$   
THREE PLACE DECIMAL  $\pm 0.003$   
FOUR PLACE DECIMAL  $\pm 0.0005$

INTERPRET GEOMETRIC  
TOLERANCING PER:

MATERIAL  
Polycarbonate

FINISH

DO NOT SCALE DRAWING

	NAME	DATE
DRAWN	B. Mowers	12/15/15
CHECKED		
ENG APPR.		
MFG APPR.		
Q.A.		

COMMENTS:  
1. Break all edges

TITLE:  
**Interlock\_Tab**  
**P/N: 180011.2**

SIZE	DWG. NO.	REV

**Main Chamber\_Rev**

SCALE: 1:12 WEIGHT: 4 SHEET 17 OF 17

**PROPRIETARY AND CONFIDENTIAL**  
THE INFORMATION CONTAINED IN THIS  
DRAWING IS THE SOLE PROPERTY OF  
RIT KGCOE MSD-P16680. ANY  
REPRODUCTION IN PART OR AS A WHOLE  
WITHOUT THE WRITTEN PERMISSION OF  
RIT KGCOE MSD-P16680 IS  
PROHIBITED.

4

3

2

1

B

B

A

A