

Concept 1

○ : pulley w/ rope] - adjustable height
 □ : hook

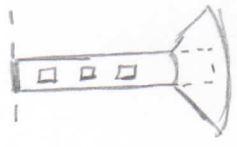

Detachable 4' sections



Far Support:

Middle & End Support



4' sections of extruded Aluminum (rectangle cross section)
 peg & latch connection

Track

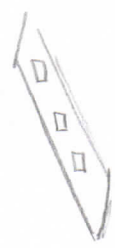

1' foldable sections containing 3 LEDs per foot (DIY)

LED

Concept 2

Far & Middle Support

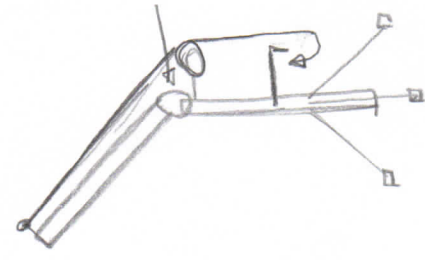
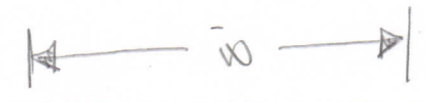
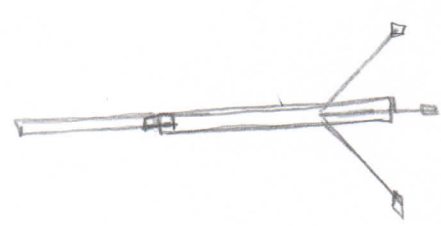

Pivot point for adjustable height

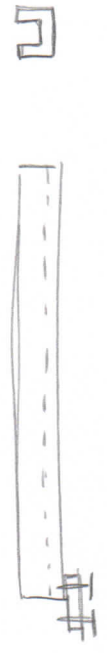
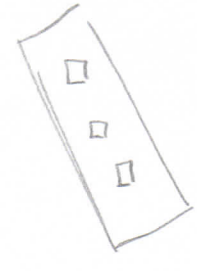

4' sections of extruded
Aluminum U-channel
screw/bracket connection

Track

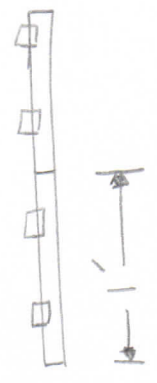

1' rollable sections containing
3 LEDs per foot
(DIY)

LED

Concept 3



4' sections of aluminum tubing with screw connectors as seen in Dr. Edmunds' office



Roll up LED strip (purchased)

LED



All Supports

Hanging Structure As Seen at Dr. Edmunds' Office